

**Licensing Act 2003 Premises Licence Number: WS/PRL/1132**

(Walsall Council reference WK/202010410)

**Part 1 – Premises details**

**Postal address of premises, or if none, ordnance survey map reference or description**

Memoirs Lounge, Bar & Grill  
Ground Floor  
2 Bradford Place  
Walsall  
WS1 1PL

**Telephone number of premises**

**Where the licence is time limited the dates**

The licence is not time limited

**Subject to the conditions set out in this licence and its annexes, the following licensable activities are licensed:**

Exhibition of Films  
Indoor Sporting Events  
Live Music  
Recorded Music  
Performance of Dance  
Activities similar to Live or Recorded Music or Performance of Dance  
Late Night Refreshment  
Alcohol Sales

**The times the licence authorises the carrying out of licensable activities**

Exhibition of Films, Indoor Sporting Events, Live Music, Recorded Music, Performance of Dance, Activities similar to Live or Recorded Music or Performance of Dance

Monday to Sunday 09:00 to 03:00

Late Night Refreshment

Monday to Sunday 23:00 – 02:30

**Alcohol Sales**

Monday to Sunday 09:00 – 02:30

Plus non-standard times as detailed in operating schedule (Annex 2)

**The opening hours of the premises**

Monday to Sunday 09:00 – 03:30

Plus non-standard times as detailed in operating schedule (Annex 2)

**Where the licence authorises supplies of alcohol whether these are on and/or off supplies**

Both “On” and “Off”

**Part 2 – Details of Licence Holder**

**Name, (registered) address, telephone number and e-mail (where relevant) of holder of premises licence**

Ms Sanjeet Mann

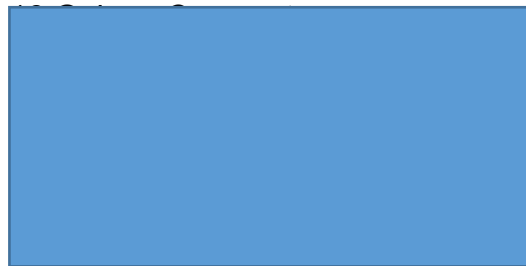

**Registered number of holder, for example company number, charity number (where applicable)**

Not applicable

**Part 3 – Details of Designated Premises Supervisor**

**Name, address and telephone number of designated premises supervisor where the premises licence authorises the supply of alcohol**

Mr Davinder Sangha



**Personal licence number and issuing authority of personal licence held by designated premises supervisor where the premises licence authorises the supply of alcohol**

Personal Licence Number – 37258  
Licensing Authority – Sandwell Borough Council

**Part 4 – Licence approval**

**Approved on behalf of Walsall Metropolitan Borough Council**

A handwritten signature in black ink, appearing to read 'D Elrington'.

David Elrington  
Regulatory Services Manager

Effective from: 17 July 2020 (*original licence issued 14 February 2019*)

## Annex 1 - Mandatory conditions

### **The following conditions apply where relevant:**

#### **Conditions that apply to the sale of Alcohol:**

No supply of alcohol may be made under this licence;

- (a) At a time when there is no Designated Premises Supervisor in respect of this licence, or
- (b) at a time when the Designated Premises Supervisor does not hold a personal Licence or his/her personal licence is suspended

Every supply of alcohol under this licence must be made or authorised by a person who holds a personal licence

#### **Conditions that apply to Security:**

Each individual at the premises in order to carry out security activity must be licensed by the Security Industry Authority (SIA).

#### **Conditions that apply to the exhibition of films:**

Where a film classification body has specified that the exhibition of a film is restricted, the admission of children to the film must be restricted in accordance with the recommendations of that body.

#### **Mandatory Licensing Conditions (Amendment) Order 2014**

1. (1) The responsible person must ensure that staff on relevant premises do not carry out, arrange or participate in any irresponsible promotions in relation to the premises.
- (2) In this paragraph, an irresponsible promotion means any one or more of the following activities, or substantially similar activities, carried on for the purpose of encouraging the sale or supply of alcohol for consumption on the premises—
  - (a) games or other activities which require or encourage, or are designed to require or encourage, individuals to—

- (i) drink a quantity of alcohol within a time limit (other than to drink alcohol sold or supplied on the premises before the cessation of the period in which the responsible person is authorised to sell or supply alcohol), or
    - (ii) drink as much alcohol as possible (whether within a time limit or otherwise);
  - (b) provision of unlimited or unspecified quantities of alcohol free or for a fixed or discounted fee to the public or to a group defined by a particular characteristic in a manner which carries a significant risk of undermining a licensing objective;
  - (c) provision of free or discounted alcohol or any other thing as a prize to encourage or reward the purchase and consumption of alcohol over a period of 24 hours or less in a manner which carries a significant risk of undermining a licensing objective;
  - (d) selling or supplying alcohol in association with promotional posters or flyers on, or in the vicinity of, the premises which can reasonably be considered to condone, encourage or glamorise anti-social behaviour or to refer to the effects of drunkenness in any favourable manner;
  - (e) dispensing alcohol directly by one person into the mouth of another (other than where that other person is unable to drink without assistance by reason of disability).
2. The responsible person must ensure that free potable water is provided on request to customers where it is reasonably available.
3. (1) The premises licence holder or club premises certificate holder must ensure that an age verification policy is adopted in respect of the premises in relation to the sale or supply of alcohol.
- (2) The designated premises supervisor in relation to the premises licence must ensure that the supply of alcohol at the premises is carried on in accordance with the age verification policy.
- (3) The policy must require individuals who appear to the responsible person to be under 18 years of age (or such older age as may be specified in the policy) to produce on request, before being served alcohol, identification bearing their photograph, date of birth and either—

- (a) a holographic mark, or
- (b) an ultraviolet feature.

4. The responsible person must ensure that—

- (a) where any of the following alcoholic drinks is sold or supplied for consumption on the premises (other than alcoholic drinks sold or supplied having been made up in advance ready for sale or supply in a securely closed container) it is available to customers in the following measures—
  - (i) beer or cider: ½ pint;
  - (ii) gin, rum, vodka or whisky: 25 ml or 35 ml; and
  - (iii) still wine in a glass: 125 ml;
- (b) these measures are displayed in a menu, price list or other printed material which is available to customers on the premises; and
- (c) where a customer does not in relation to a sale of alcohol specify the quantity of alcohol to be sold, the customer is made aware that these measures are available.”

### **Mandatory Licensing Conditions Order 2014**

1. A relevant person shall ensure that no alcohol is sold or supplied for consumption on or off the premises for a price which is less than the permitted price.
2. In this condition:—
  - (a) “permitted price” is the price found by applying the formula  $P = D + (D \times V)$ , where—
    - (i) P is the permitted price,
    - (ii) D is the amount of duty chargeable in relation to the alcohol as if the duty were charged on the date of the sale or supply of the alcohol, and
    - (iii) V is the rate of value added tax chargeable in relation to the alcohol as if the value added tax were charged on the date of the sale or supply of the alcohol;
  - (b) “duty” is to be construed in accordance with the Alcoholic Liquor Duties Act 1979;
  - (c) “relevant person” means, in relation to premises in respect of which there is in force a premises licence—
    - (i) the holder of the premises licence,
    - (ii) the designated premises supervisor (if any) in respect of such a licence, or

- (ii) the personal licence holder who makes or authorises a supply of alcohol under such a licence;
  - (d) “relevant person” means, in relation to premises in respect of which there is in force a club premises certificate, any member or officer of the club present on the premises in a capacity which enables the member or officer to prevent the supply in question; and
  - (e) “value added tax” means value added tax charged in accordance with the Value Added Tax Act 1994.
3. Where the permitted price would not be a whole number of pennies, the permitted price shall be taken to be the price rounded up to the nearest penny.
  4. Where the permitted price on a day (“the first day”) would be different from the permitted price on the next day (“the second day”) as a result of a change to the rate of duty or value added tax, the permitted price which would apply on the first day applies to sales or supplies of alcohol which take place before the expiry of the period of 14 days beginning on the second day.
  5. Where the permitted price would not be a whole number of pennies, the permitted price shall be taken to be the price rounded up to the nearest penny.
  6. Where the permitted price on a day (“the first day”) would be different from the permitted price on the next day (“the second day”) as a result of a change to the rate of duty or value added tax, the permitted price which would apply on the first day applies to sales or supplies of alcohol which take place before the expiry of the period of 14 days beginning on the second day.

## Annex 2 - Conditions consistent with the Operating Schedule

Exhibition of films Indoors			
Day	Start	Finish	Non-standard times: Saturday & Sunday of Bank Holiday Weekends & Christmas Eve- 09:00 to 03:30  New Year's Eve 09:00 to 04:00
Mon	09:00	03:00	
Tues	09:00	03:00	
Wed	09:00	03:00	
Thurs	09:00	03:00	
Fri	09:00	03:00	
Sat	09:00	03:00	
Sun	09:00	03:00	

Indoor Sporting Events			
Day	Start	Finish	Non-standard times: Saturday & Sunday of Bank Holiday Weekends & Christmas Eve- 09:00 to 03:30  New Year's Eve 09:00 to 04:00
Mon	09:00	03:00	
Tues	09:00	03:00	
Wed	09:00	03:00	
Thurs	09:00	03:00	
Fri	09:00	03:00	
Sat	09:00	03:00	
Sun	09:00	03:00	



Live Music  
Indoors

Day	Start	Finish	Non-standard times: Saturday & Sunday of Bank Holiday Weekends & Christmas Eve- 09:00 to 03:30  New Year's Eve 09:00 to 04:00
<b>Mon</b>	09:00	03:00	
<b>Tues</b>	09:00	03:00	
<b>Wed</b>	09:00	03:00	
<b>Thurs</b>	09:00	03:00	
<b>Fri</b>	09:00	03:00	
<b>Sat</b>	09:00	03:00	
<b>Sun</b>	09:00	03:00	

Recorded Music  
Indoors

Day	Start	Finish	Non-standard times: Saturday & Sunday of Bank Holiday Weekends & Christmas Eve- 09:00 to 03:30  New Year's Eve 09:00 to 04:00
<b>Mon</b>	09:00	03:00	
<b>Tues</b>	09:00	03:00	
<b>Wed</b>	09:00	03:00	
<b>Thurs</b>	09:00	03:00	
<b>Fri</b>	09:00	03:00	
<b>Sat</b>	09:00	03:00	
<b>Sun</b>	09:00	03:00	

Performance of Dance  
Indoors

Day	Start	Finish	Non-standard times: Saturday & Sunday of Bank Holiday Weekends & Christmas Eve- 09:00 to 03:30  New Year's Eve 09:00 to 04:00
<b>Mon</b>	09:00	03:00	
<b>Tues</b>	09:00	03:00	
<b>Wed</b>	09:00	03:00	
<b>Thurs</b>	09:00	03:00	
<b>Fri</b>	09:00	03:00	
<b>Sat</b>	09:00	03:00	
<b>Sun</b>	09:00	03:00	

Activities similar to Live or Recorded Music or Performance of Dance  
Indoors

Day	Start	Finish	Non-standard times: Saturday & Sunday of Bank Holiday Weekends & Christmas Eve- 09:00 to 03:30  New Year's Eve 09:00 to 04:00
<b>Mon</b>	09:00	03:00	
<b>Tues</b>	09:00	03:00	
<b>Wed</b>	09:00	03:00	
<b>Thurs</b>	09:00	03:00	
<b>Fri</b>	09:00	03:00	
<b>Sat</b>	09:00	03:00	
<b>Sun</b>	09:00	03:00	

Late Night Refreshment  
Indoors

Day	Start	Finish
Mon	23:00	02:30
Tues	23:00	02:30
Wed	23:00	02:30
Thurs	23:00	02:30
Fri	23:00	02:30
Sat	23:00	02:30
Sun	23:00	02:30

Alcohol Sales

Both On & Off Premises

Day	Start	Finish	
Mon	09:00	02:30	Non-standard times: Saturday & Sunday of Bank Holiday Weekends & Christmas Eve- 09:00 to 03:30  New Year's Eve 09:00 to 03:45
Tues	09:00	02:30	
Wed	09:00	02:30	
Thurs	09:00	02:30	
Fri	09:00	02:30	
Sat	09:00	02:30	
Sun	09:00	02:30	

## Opening Hours

Day	Start	Finish	Non-standard times:
Mon	09:00	03:30	Saturday & Sunday of Bank Holiday Weekends & Christmas Eve- 09:00 to 04:30  New Year's Eve 09:00 to 04:30
Tues	09:00	03:30	
Wed	09:00	03:30	
Thurs	09:00	03:30	
Fri	09:00	03:30	
Sat	09:00	03:30	
Sun	09:00	03:30	

**The following adult entertainment or services, activities or other matters ancillary to the use of the premises that might give rise to concern in respect of children have been highlighted by the applicant:**

None

**Conditions volunteered by the applicant in order to promote the licensing objectives:**

**(a) General – all four licensing objectives**

The Licence holder will ensure all staff receive adequate training on a regular basis relating to the four licensing objectives, general licencing regulations/conditions, including Fire regulations. A record of the training will be kept by the Licence holder

The Licence holder will ensure that the external areas of the premises are monitored to prevent any noise nuisance or anti-social behaviour.

**(b) The prevention of crime and disorder**

Customers will not be permitted to carry open bottles or glasses beyond the licensed area. Empty glasses and bottles will be cleared when finished with.

CCTV system will be installed and fit for the purpose and satisfaction of West Midlands Police.

Images will be retained for at least 31 days and shall be made available upon request to officers of the responsible authorities.

Staff will be given ongoing training including identification of anti-social or unusual behaviour

**(c) Public safety**

Adequate Lighting will be provided both inside and outside of the premises

The Licence holder will ensure Electric, Gas, and relevant equipment are checked and maintained in working order and tested annually.

**(d) The prevention of public nuisance**

The Designated Premises Supervisor will provide responsible management at all times

The noise from the premises will be monitored so as not to become a public nuisance.

Notices will be posted asking patrons to leave quietly

The disposal of empties and bottles will not be done after 23:00 Hours or before 07:00 Hours.

An incident register will be kept on the premises and made available at all times.

**(e) The protection of children from harm**

A Challenge 25 policy will be operated with notices informing customers of the policy. The only forms of acceptable identification shall be a photographic driving license, a valid passport or any other recognised form of photographic identification incorporating the PASS logo. Notices to this effect will be displayed within the premises.

Staff will be regularly trained and reminded to enforce the Challenge 25 policy. All training will be recorded and records available to responsible authorities for inspection.

The Licence holder will ensure all employees are fully trained and aware of the challenge 25 rule.

All alcohol sale refusals will be noted in a refusals register, which will be maintained at the premises and made available for inspection by any of the regulatory authorities.

The Premises License holder will ensure that notices stating no sales of alcohol to persons under 18 years of age are displayed at all bars within the premises.

Notices stating it is illegal for persons to buy alcohol on behalf of persons under 18 years of age will be displayed at all bars within the premises.

The premises licence holder shall ensure that staff are fully conversant with the legal prohibitions in relation to the sale of alcohol to under 18s

There will be a provision of sufficient staff to protect children from harm with training on appropriate behaviour.

**Conditions agreed by the applicant following mediation**

None

**Annex 3 - Conditions attached after a hearing by the licensing authority**

Not applicable - this application was not subject to a hearing.

**Annex 4 – Plans**

Plans detailing those aspects of the premises covered by this Licence form part of this Licence and are attached.

**End of annexes**

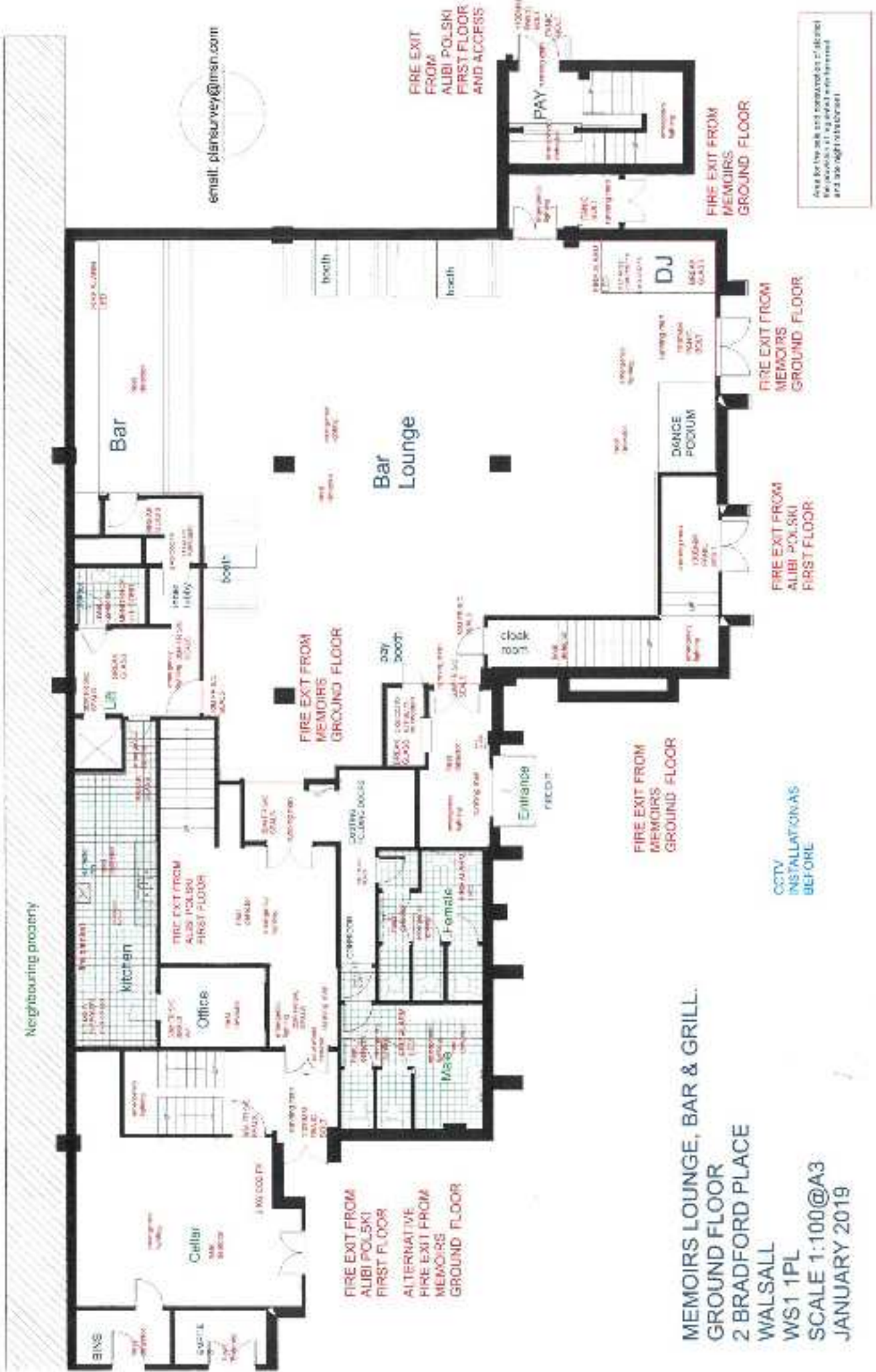

email: plansurvey@tmsn.com

Area for the sale and installation of alcohol  
for persons 17 and over only (licensed  
and age-restricted)

MEMOIRS LOUNGE, BAR & GRILL.  
GROUND FLOOR  
2 BRADFORD PLACE  
WALSALL  
WS1 1PL  
SCALE 1:100@A3  
JANUARY 2019

CCTV  
INSTALLATIONS  
BEFORE