



PLANNING COMMITTEE: –

29th July 2010

REPORT OF THE HEAD OF REGENERATION – DEVELOPMENT AND DELIVERY

CONFIRMATION OF TREE PRESERVATION ORDER 20 OF 2009 ON DARLASTON COMMUNITY SCHOOL, HERBERTS PARK ROAD, DARLASTON AND (PART OF) GEORGE ROSE PARK, WOLVERHAMPTON STREET, DARLASTON

1. PURPOSE OF REPORT

To seek the confirmation of the Tree Preservation Order No 20 of 2009 in an unmodified form.

2. RECOMMENDATIONS

The Committee is recommended to:

- (i) Confirm the Walsall Tree Preservation Order No 20 of 2009 in an unmodified form. A plan showing the Tree Preservation Order is attached to this report.
- (ii) Support the reason for making the Tree Preservation Order set out in the report detail, paragraph 10.
- (iii) Note that no representations have been received in respect of this Tree Preservation Order.

3. FINANCIAL IMPLICATIONS

Within budget, in general, new Tree Preservation Orders generate additional applications for consent and increase officers' workload.

4. POLICY IMPLICATIONS

Within Council policy – YES

5. LEGAL IMPLICATIONS

The owners and future owners of this site will be required to apply for Council permission if they wish to fell or prune any tree protected by the Tree Preservation

Order. Failure to do this renders anyone carrying out unauthorised works to trees liable to criminal proceedings.

6. EQUAL OPPORTUNITY IMPLICATIONS

NOT APPLICABLE

7. ENVIRONMENTAL IMPACT

The management of Walsall's tree cover through the administration of the Tree Preservation Order system has positive implications in protecting trees for their visual and environmental benefits. Removal of protected trees is often necessary because trees have a finite lifespan and may also cause nuisance or damage. In these instances the Council has to decide whether the removal of protected trees is justified. In the event that felling a tree is permitted, the Council can secure replacement planting to maintain tree cover.

8. WARD(S) AFFECTED

The Tree Preservation Order 20 of 2009 is located within the Darlaston South Ward.

9. CONSULTEES

Owners and near neighbours were sent copies of the Tree Preservation Order and invited to make representations to the Council in either opposition or support of this Tree Preservation Order. Any response is described within the report.

10. REPORT DETAIL

- 10.1 The Tree Preservation Order No 20 of 2009 was made on 19th January 2010. The trees vary in age ranges and are of good shape, form and condition, and are visually prominent in the street scene. They were protected for the following reasons;

- The trees form a prominent landscape feature in the local area and will continue to contribute to landscape quality in the future.
- The site has been granted Outline Planning Consent (reference 09/1130/OL) for the redevelopment of the Community College on an enlarged site including part of George Rose Park for a 1500 place school. However, no application for Reserved Matters has been submitted to date. The TPO will discourage the removal of these trees until such an application can be considered.
- The trees add to the amenity and visual diversity of the immediate area and provide a valuable screen between the site and the residential properties to the south. They are also important for foraging bats.

- The Council's Unitary Development Plan identifies policies for protection of the trees and green spaces.

10.2 The minimum six week period allowed for objection to the Order expired on 18th February 2010. No responses have been received.

10.3 The Committee is therefore recommended to confirm Tree Preservation Order No 20 of 2009 in its unmodified form.

11. **CONTACT OFFICER**

Cameron Gibson - Extension: 2453

12. **BACKGROUND PAPERS**

File PD1/17/897 relating to Tree Preservation Order No 20 of 2009.

Simon Tranter,
HEAD OF REGENERATION – DEVELOPMENT AND DELIVERY

DEVELOPMENT CONTROL COMMITTEE: –

29th July 2010

**CONFIRMATION OF TREE PRESERVATION ORDER 20 OF 2009 ON
DARLASTON COMMUNITY SCHOOL, HERBERTS PARK ROAD,
DARLASTON AND (PART OF) GEORGE ROSE PARK,
WOLVERHAMPTON STREET, DARLASTON**

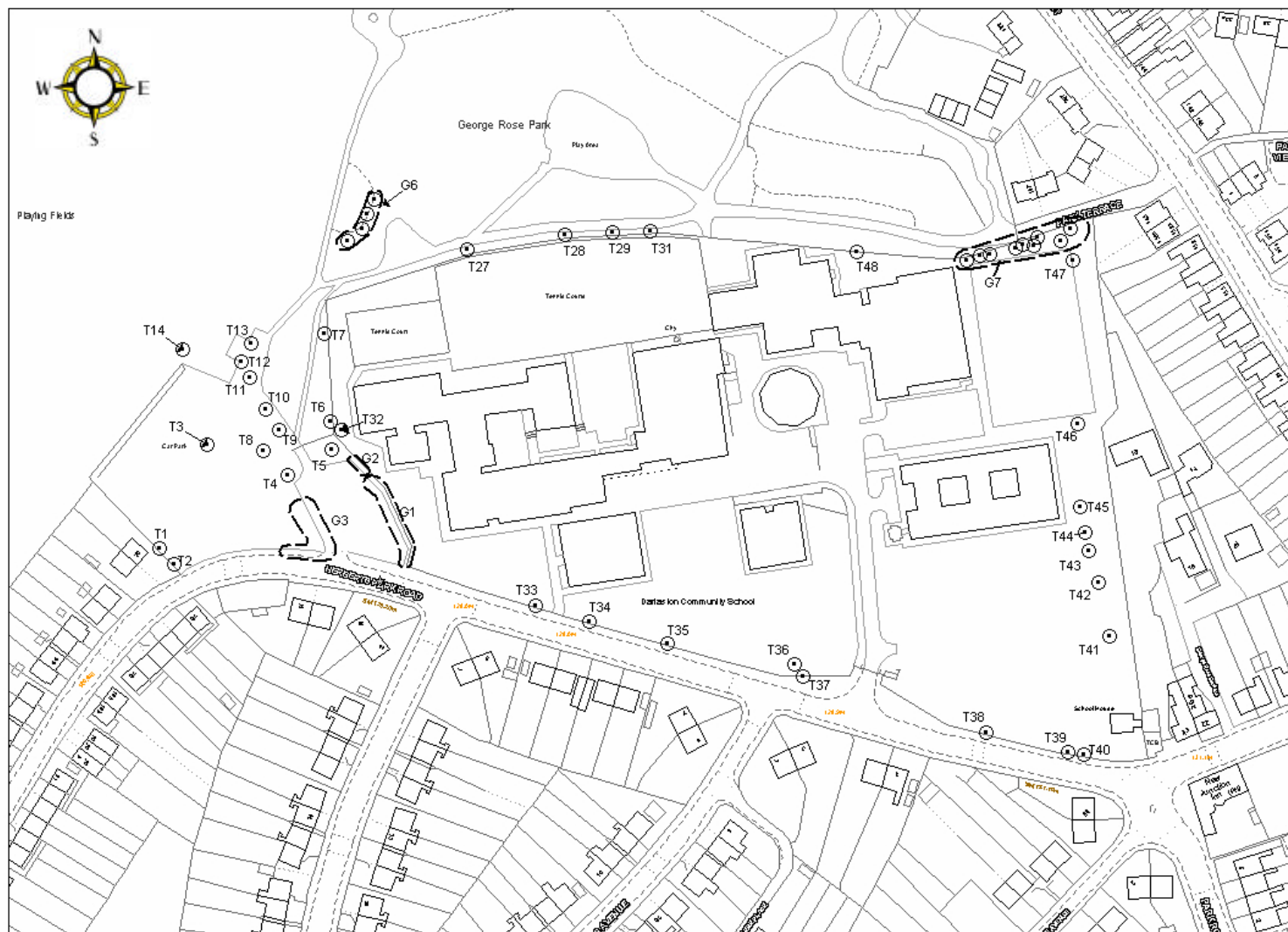

Walsall Council

TPO 20 of 2009
 Darlaston Community School, Herberts Park Rd and (part of) George Rose Park,
 Wolverhampton St, Darlaston.
 Map 1 of 2.

Scale: Unknown
 Date: 27/10/2009
 Centre: 396847E
 296817N

Reproduced from the Ordnance Survey mapping with the permission of Her Majesty's Stationery Office. Crown Copyright reserved. Unauthorised reproduction infringes Crown Copyright and may lead to prosecution or civil proceedings. LICENCE NO: 100019529



TPO 20 of 2009

Darlaston Community School, Herberts Park Rd and (part of) George Rose Park, Wolverhampton St, Darlaston.

Map 2 of 2.

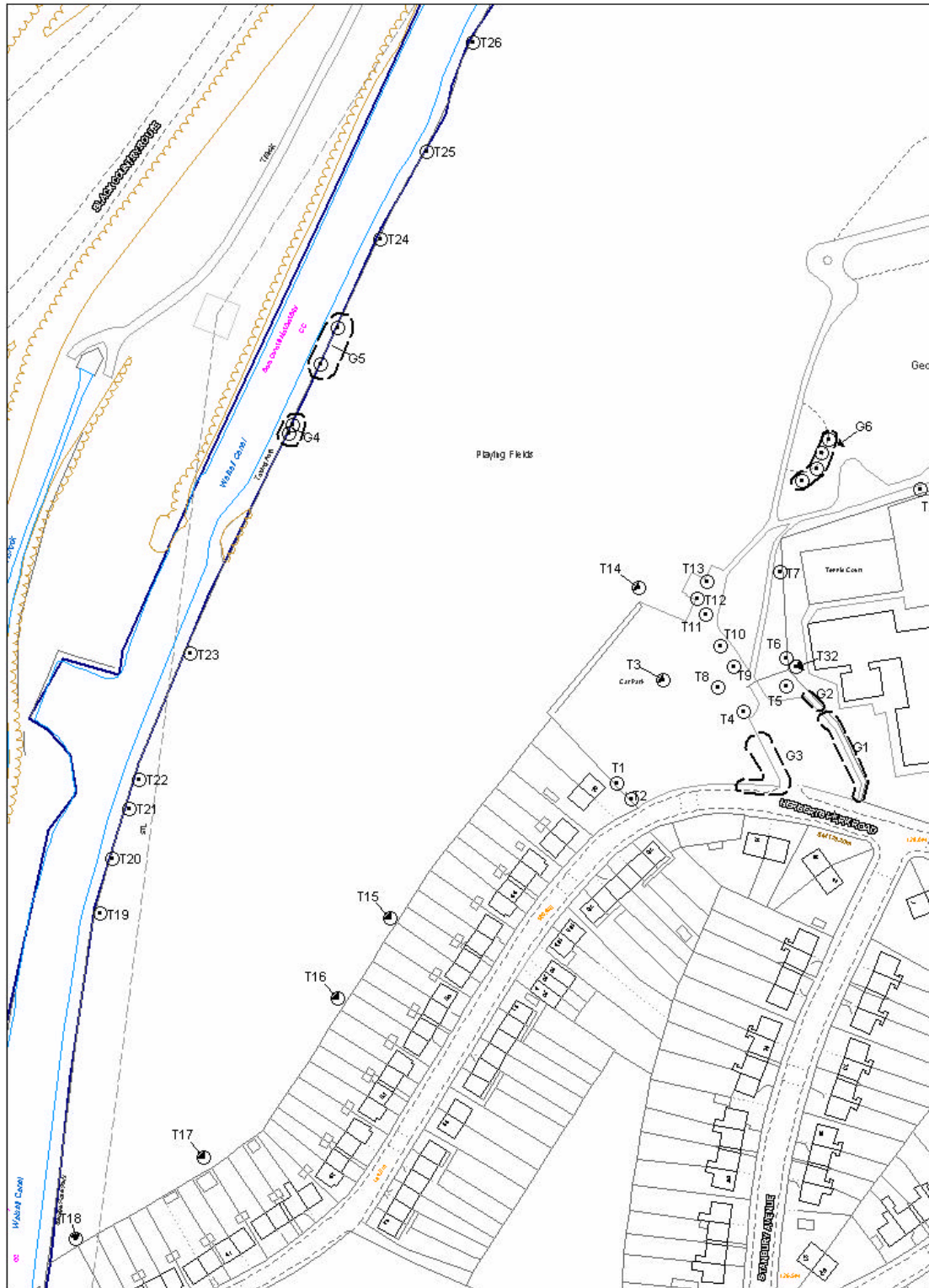

Not to Scale Date 27 October 2009 Centre 396847E 296817N Cameron Gibson

Reproduced from the Ordnance Survey mapping with the permission of Her Majesty's Stationary Office. Crown Copyright reserved.
Unauthorised reproduction infringes Crown Copyright and may lead to prosecution or civil proceedings LICENCE NO : 100019529