

| | | |
|---|--|--------------------------------|
|  | <p style="text-align: center;">ST MATTHEWS AND BIRCHILLS- LEAMORE LOCAL NEIGHBOURHOOD PARTNERSHIP</p> <p style="text-align: center;">12 October 2004</p> | <p>AGENDA ITEM:</p> |
| <p>TRANSFORMING YOUR SPACE PROGRAMME</p> <p>Ward(s): St Matthews and Birchills-Leamore Local Neighbourhood Partnership boundary area.</p> | | |
| <p>Portfolio: Councillor A. Andrew</p> <p>Service Area: Urban Regeneration</p> <p>Summary of Report:</p> <p>This report outlines Walsall's Transforming Your Space Programme (TYS).</p> <p>TYS is a "Big Lottery Fund", formerly New Opportunities Fund (NOF), initiative of environmental projects and play and youth schemes across the borough of Walsall. The programme consists of 14 large projects which are all due to be complete by September 2006. TYS has and will continue to work in partnership with the Local Strategic Partnership (LSP), Community Empowerment Network (CEN), and local groups and residents. The programme totals just over £2.7 million in funding, with £1.7 million of this being secured from the Big Lottery Fund.</p> <p>This report provides details of the TYS projects due to be implemented in the St Matthews and Birchills-Leamore LNP area and seeks authority for the proposals to be included in the final local neighbourhood plan.</p> | | |
| <p>Background Papers:</p> <p>Transforming Your Space Programme Cabinet Report – 16th October 2002. Transforming Your Space Programme Cabinet Report – 08th September 2004.</p> | | |
| <p>Recommendations</p> <ul style="list-style-type: none"> • To note details of the Transforming Your Space Programme in Walsall. • To endorse the proposals detailed for the St Matthews and Birchills-Leamore LNP and include these in the final local neighbourhood plan. | | |

Resource and Legal Considerations

Transforming Your Space is a Big Lottery Fund grant of £1,748,294. With match funding, the programme totals approximately £2.7 million.

There are no known legal considerations, other than the sealing of individual contracts exceeding £100,000.

Citizen Impact

The TYS programme will have a borough wide impact and will benefit a broad range of Walsall's population. In particular, young people will directly benefit through access to improved play and recreational facilities.

Environment Impact

The programme includes environmental improvement projects and improvements to play and youth facilities, therefore there will be a positive impact on the environment.

Performance Management and Risk Management Issues

The TYS programme contributes to the Environmental Regeneration Service objective to "developing and delivering a range of environmental regeneration initiatives which improve the quality of life for people in the borough."

Risk Management Issues:

Risk

Failure to obtain LNP approval for the inclusion of TYS projects in their final local neighbourhood plan: This risk is considered to be low given the extent to which local people and existing partners have been involved in the development process for the TYS programme.

Equality Implications

The TYS programme will have a borough wide impact, ensuring that every part of Walsall sees some form of activity.

The processes used to identify the TYS projects have been scrutinised by the borough's CEN.

Consultation

To date the programme has been developed in consultation with local communities, the

LSP (in particular the Housing and Environment Theme Group), the borough CEN, Friend of Parks groups and all the former District Committees. These and other groups will continue to play an important part in the programme.

Vision 2008

The programme will contribute to the following Council Priorities, identified in Vision 2008:

- Ensure a clean & green borough
- Ensure all people are safe & secure
- Make Walsall a healthy and caring place
- Encourage everyone to feel proud of Walsall
- Make it easier to access local services
- Listen to what people want

Contact Officers:

Steve Lewis
Head of Environmental Regeneration
Ext. 2534
Lewiss@walsall.gov.uk

Kauser Agha
Transforming Your Space Coordinator
Ext.2538
Aghak@walsall.gov.uk

1. PURPOSE OF REPORT

- 1.1 To inform the St Matthews and Birchills-Leamore LNP about the Transforming Your Space (TYS) programme in Walsall.
- 1.2 To provide details of the YYS projects due to be implemented in the St Matthews and Birchills-Leamore LNP area.
- 1.3 To seek the St Matthews and Birchills-Leamore LNPs approval for the YYS projects to be included within their final local neighbourhood plan.

2. THE TRANSFORMING YOUR SPACE PROGRAMME

- 2.1 The Big Lottery Fund, formerly The New Opportunities Fund (NOF), allocated £1.7 million to Walsall Council under its Fair Share Initiative in October 2002. The Fair Share Initiative was launched in recognition that not all parts of the Country were receiving their “fair share” of lottery funding. The allocation was made following the successful submission of an umbrella scheme for Walsall that would target not only the 11 priority areas identified by the Walsall Borough Strategic Partnership (WBSP) (strand 1 – environmental improvement projects in WBSP “priority neighbourhoods”) but also the whole borough (strand 2 – borough wide play and youth schemes). This was stage 1 of the application process.
- 2.2 Stage 2 of the application process involved the submission of a portfolio of projects to NOF by 31st August 2003. Part of the criteria for the submission included the endorsement of the portfolio by the Local Strategic Partnership (LSP) prior to 31st August. This deadline was met by working in partnership with the LSP, Community Empowerment Network (CEN) and local community organisations. The LSP endorsed the portfolio at their meeting on 18th August 2003. Prior to this, the projects were appraised by the LSP’s Housing and Environment Theme Group, and the processes used were scrutinised by the CEN to ensure that all projects had been inclusive and developed in partnership with the local community (a condition set by the Big Lottery Fund). All the former District Committees endorsed the strand 2 package in April 2003.
- 2.3 The portfolio of projects, approved by the Big Lottery Fund in November 2003, includes 14 large projects ranging from environmental improvement proposals to improved play and youth facilities across all six of the former District Committee areas.
- 2.4 Progress to date
 - 2.4.1 Of the 14 projects, 2 pilot projects, Caldmore Junior School Multi-Sports Provision (strand 1) and the Walsall District and Town Centre Project (a package of 7 schemes: Arboretum, Beechdale Park, Pleck Park, Palfrey Park, Reedswood Park, Silverdale Park and WS2 Skate Park) (strand 2) have been developed and are anticipated to be on site during autumn 2004. The remaining 12 projects will then be developed and implemented in accordance with the timetable approved by the Big Lottery Fund, with all projects being complete by September 2006 (a grant condition).

3. THE VISION

3.1 TYS contributes to Walsall's Vision for 2008, relating to 6 of the 10 identified priorities:

- Ensure a clean and green borough – the implementation of the planned projects will encourage people to take pride in their open spaces, parks, and general environment. The TYS process has and will continue to increase community participation in Walsall's parks.
- Ensure all people are safe & secure – the improvement of key sites will help increase safety and thus encourage more people to use the facilities. It is also hoped that the new/improved facilities for young people, such as multi use games areas, will provide diversionary activities for this vulnerable age group.
- Make Walsall a healthy and caring place – better recreational facilities will encourage people to use these more often, promoting interaction and well-being. Enhanced facilities will also encourage the young to participate in energetic activities, helping reduce obesity in the borough.
- Encourage everyone to feel proud of Walsall – the £2.7 million investment will help improve Walsall's image.
- Make it easier to access local services – the planned improvements will make it easier for people to access their local green/open spaces, parks and play areas. One of the key issues each project will look at is access; every effort will be made to ensure that as many sections of the community can use the improved facilities.
- Listen to what local people want – TYS is a community led programme, which will continue to involve and listen to local people. The CEN has also been involved in scrutinising the processes used for community engagement.

4. TYS LAUNCH

4.1 To celebrate and publicise the award, inform people about the forthcoming projects, and highlight the importance of the programme for Walsall and its community; the TYS programme was 'launched' in the Town Hall on Friday 16th July 2004. The event was hosted by Chief Executive Annie Shepperd and was attended by Bruce George MP, Richard Shepherd MP, Ward Councillors, community representatives, Council Officers and representatives from the Big Lottery Fund.

5. TYS WEBSITE

5.1 A website for TYS has been developed and was launched on 16th July. The website will not only inform people about the programme but will also act as a major consultation tool, enabling project specific comments to be made directly via email. Subsequently, the website has been commended by the Big Lottery Fund as an example of good practice. The address for the site is www.walsall.gov.uk/tys/. Details of all the projects can be found on the site, including project description, sketch schemes and site photos. The website will become a living record of the Programme.

6. TYS PROJECTS IN THE ST MATTHEWS AND BIRCHILLS-LEAMORE LNP AREA

6.1 The approved TYS proposals for the St Matthews and Birchills-Leamore LNP area are detailed below. The sketch schemes for these proposals are attached in appendix 1.

6.2 Caldmore Junious School Multi Sports Provision

6.2.1 The Project will provide a new high quality sporting facility for football hockey and netball on the existing tarmac playground within the grounds of the school. However, the facility will be for the use of both the school, during school hours, and the local community at other set times.

6.2.2 The proposals outlined above were identified by representatives on the strand 1 TYS steering group and later endorsed by the community via consultation events organised by Groundwork Walsall.

6.2.3 Work is due on site in October 2004 and anticipated to be complete in December 2004. To ensure that the final design still met the requirements of the community, further consultation was undertaken before the details were finalised. Methods utilised included displays in local facilities and on-site consultation.

6.3 Walsall District and Town Centre Project

6.3.1 The schemes that form part of the Walsall District and Town Centre Project were identified as a result of feedback from parents and young people, Friends of Parks groups and along with other schemes and projects within strand 2 by a working group of Officers. The criteria used included:

- Existing provision
- Representation/deputations received from residents
- Officer knowledge of sites
- An equal split of TYS funding across the old District Committees

In April 2003 all the former District Committees approved all the strand 2 projects.

6.3.2 Beechdale Park

A new multi-use games area with goal/basket posts will be installed.

6.3.3 Reedswood Park

The first phase of work will see the transformation of the former tennis court area into a new multi-sports facility with ball-stop fencing. The scheme also includes new tarmac paving and a youth shelter (to be located next to the multi-sports facility).

6.3.4 WS2 Skate Park

As the skate park in Walsall Town Centre is a well used facility, mobile ramp equipment will be installed inside the building to further improve the provision.

6.3.5 The Walsall District and Town Centre schemes are due on site in October 2004 and are anticipated to be complete in December 2004. To ensure that the final designs for schemes still met the requirements of the community, detailed consultation was undertaken. Various methods were utilised including displays in community facilities, friends/users groups and on-site consultation.

6.4 Beechdale Park Environmental Improvement Project

- 6.4.1 Environmental improvements to be undertaken at Beechdale Park are: the culverting (covering and redirecting) of a section of Sneyd Brook, the reinstatement of the path between Bloxwich Lane and Frank F Harrison School (a new safe route to school) and improvements to the access points to the park off Bloxwich Lane and Hadley Road.
- 6.4.2 The proposals outlined above were identified by representatives on the strand 1 TYS steering group and later endorsed by the community via consultation events organised by Groundwork Walsall.
- 6.4.3 The project is due on site in approximately May 2005 and complete in July 2005. Preceding this, there will be a detailed consultation/engagement stage which will ensure that the final designs still meet the requirements of the community. Various methods will be utilised including displays in libraries and other community facilities and the TYS website. LNP members will be informed of consultation events taking place during the detailed design stage for the project and invited to take part.

7. RISK MANAGEMENT ISSUES

- 7.1 Risk 1 - Failure to obtain LNP approval for the inclusion of TYS projects in the final local neighbourhood plan: This risk is considered to be low given the extent to which local people and existing partners have been involved in the development process for the TYS programme.

8. SUMMARY

- 8.1 TYS represents large scale environmental regeneration for Walsall borough and will contribute to improving people's quality of life.

In summary, St Matthews and Birchills-Leamore LNP is asked to:-

- Note details about the TYS Programme.
- Endorse and include the TYS proposals within the final local neighbourhood plan.

Appendix 1

TYS Sketch Schemes

TRANSFORM YOUR SPACE PROGRAMME
Caldmore Primary Multi-Sports Area,
Caldmore, Walsall

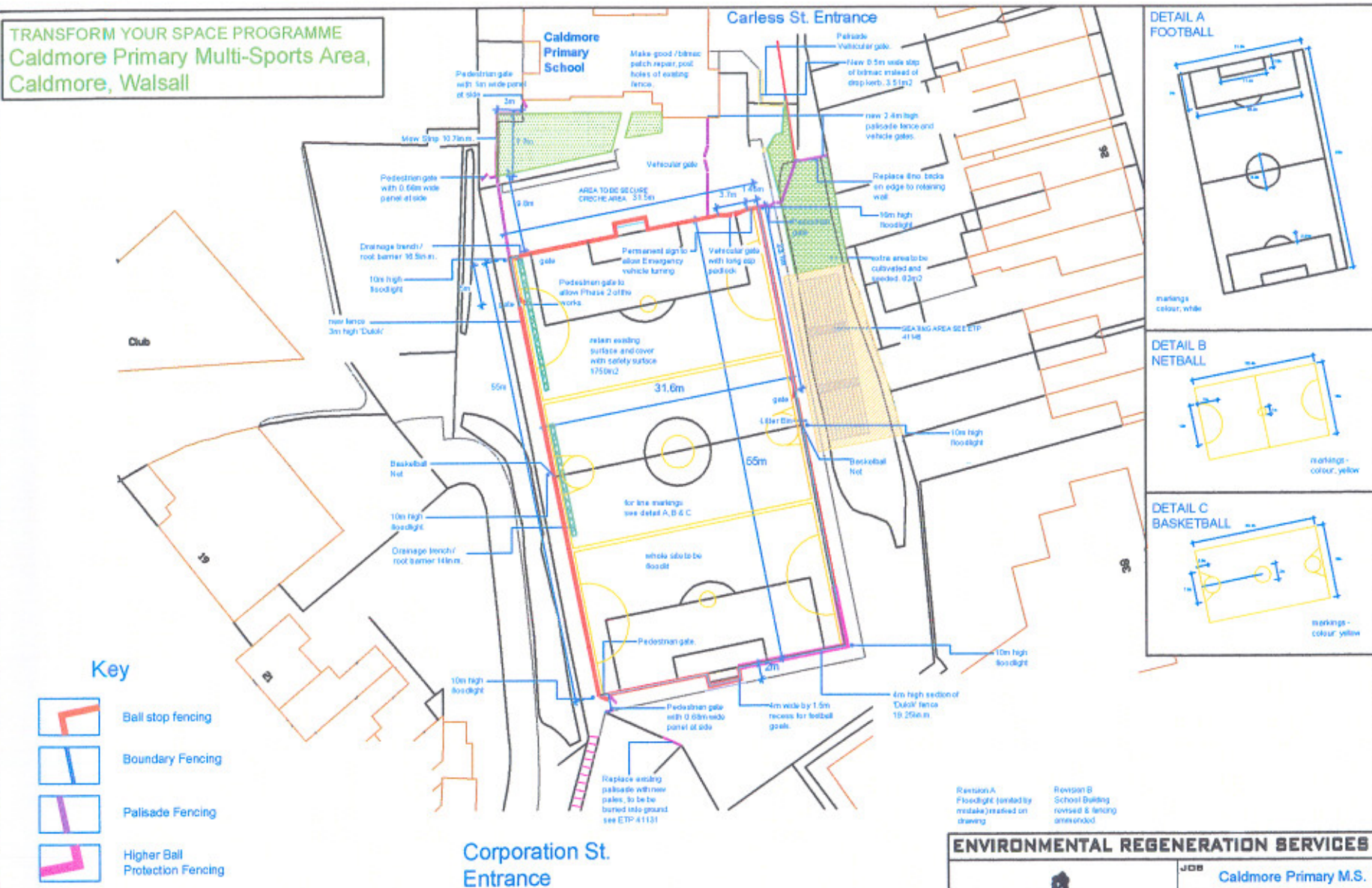

Reproduced from the Ordnance Survey mapping with the permission of the Controller of Her Majesty's Stationary Office. © Crown copyright. Unauthorised reproduction infringes Crown copyright and may lead to prosecution or civil proceedings.
Walsall Metropolitan Borough Council, Licence No LA076414.

Region A
Floodlight (installed by
mistake) raised on
driveway

Revision B
School Building
revised & being
amended

ENVIRONMENTAL REGENERATION SERVICES

WALSALL METROPOLITAN BOROUGH COUNCIL
REGENERATION
AND HOUSING PARTNERSHIP

Caldmore Primary M.S.

| | |
|-------|-------------|
| TITLE | Site Layout |
|-------|-------------|

| | | |
|---------|--------|---------------------------|
| DRAWN | J.G. | DRAWING NO. ETP 411308 |
| CHECKED | | |
| DATE | Dec 03 | |
| SCALE | 1:200 | |

TRANSFORMING YOUR SPACE BEECHDALE PARK, WALSALL.

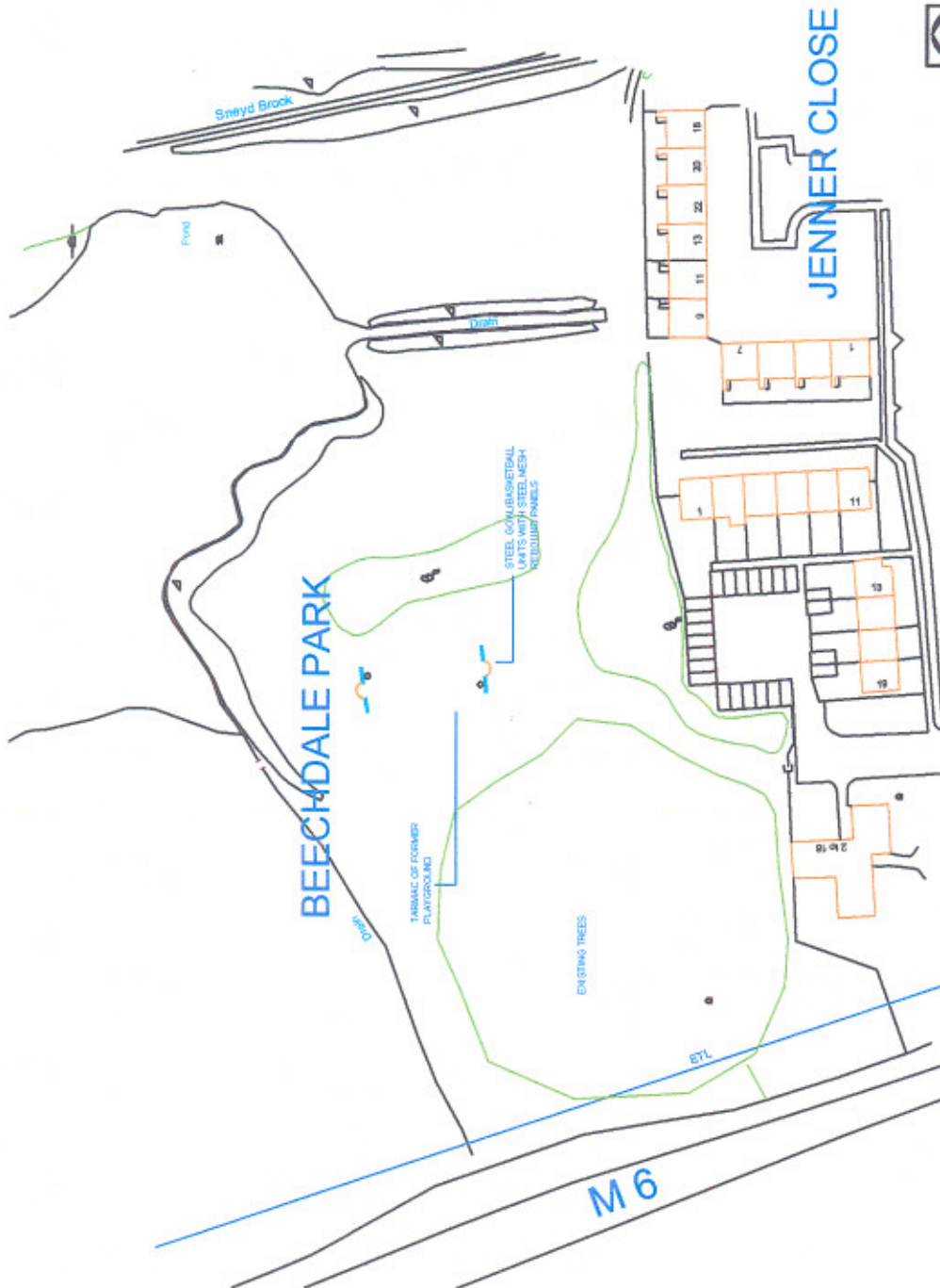

KEY



TARMAC SURFACE OF
FORMER PLAYGROUND



FOOTBALL GOAL &
BASKETBALL HOOP UNITS
WITH STEEL WESH REBOUND
PANELS

ENVIRONMENTAL REGENERATION SERVICES

100 BEECHDALE PARK, WALSALL

PROPOSED TYS SCHEME

Drawn: CB

Checked: JLS

Date: MAR 2004

ETP 41004

N.T.S.

WALSALL METROPOLITAN BOROUGH COUNCIL
Civic Centre, Barnall Street, Walsall

Reproduced from the Ordnance Survey map, with the permission of the Controller of Her Majesty's Stationery Office. Crown copyright. Unauthorised reproduction without Crown copyright may lead to legal action. Walsall Metropolitan Borough Council. Licence No. 100016020

TRANSFORMING YOUR SPACE
REEDSWOOD PARK, WALSALL.

LOCATION PLAN



KEY



EXISTING REDGRA REPLACED
WITH TARMAC SURFACING



4.0M HIGH WELDMESH BALL STOP
FENCE AROUND MULTI SPORTS AREA



MULTI SPORTS GOALREBOUND
PANELS & BASKETBALL HOOPS

NEW YOUTH SHELTER
(DESIGN TO BE APPROVED)

CLEAR RUBBISH & LEVEL SITE
OF FORMER PAVILION



TOPSOIL & TURF TO ERODED BANK



REMOVE SHRUBS AND REPLACE
WITH MORE APPROPRIATE SPECIES



EXISTING SHRUBS REMOVED &
REPLACED WITH NEW SPECIES



EXISTING TARMAC REPAIRED
WHERE DAMAGED

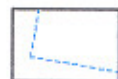

PERIMETER FRENCH DRAIN
(PROVISIONAL ITEM)



Playground



ENVIRONMENTAL REGENERATION SERVICES



| | |
|-----|----------------------------|
| 100 | REEDSWOOD PARK, WALSALL |
| 100 | PROPOSED TYS SCHEME |

| | |
|-----------------|--------------------------|
| Drawn: CB | Drawing No. ETP 41027 |
| Checked: | |
| Date: MAR. 2004 | |
| Scale: N.T.S. | |

Reproduced from the Ordnance Survey mapping with the permission of the Controller of Her Majesty's Stationery Office. © Crown copyright. Unauthorised reproduction infringes Crown copyright and may lead to prosecution or civil proceedings.
 Printed in Great Britain by the Ordnance Survey, London. No. 1000000000.

TRANSFORMING YOUR SPACE WS2 SKATE PARK, WALSALL

LOCATION PLAN



EQUIPMENT INSIDE
BUILDING TO INCLUDE
GRINDER RAIL & FUN
BOX WITH RAIL

FORMER PARKING
AREA USED FOR
INFORMAL OUTDOOR
SKATING

EXISTING BUILDING
USED FOR SKATE
PARK. PROPOSED
EQUIPMENT TO BE
LOCATED INSIDE
BUILDING.

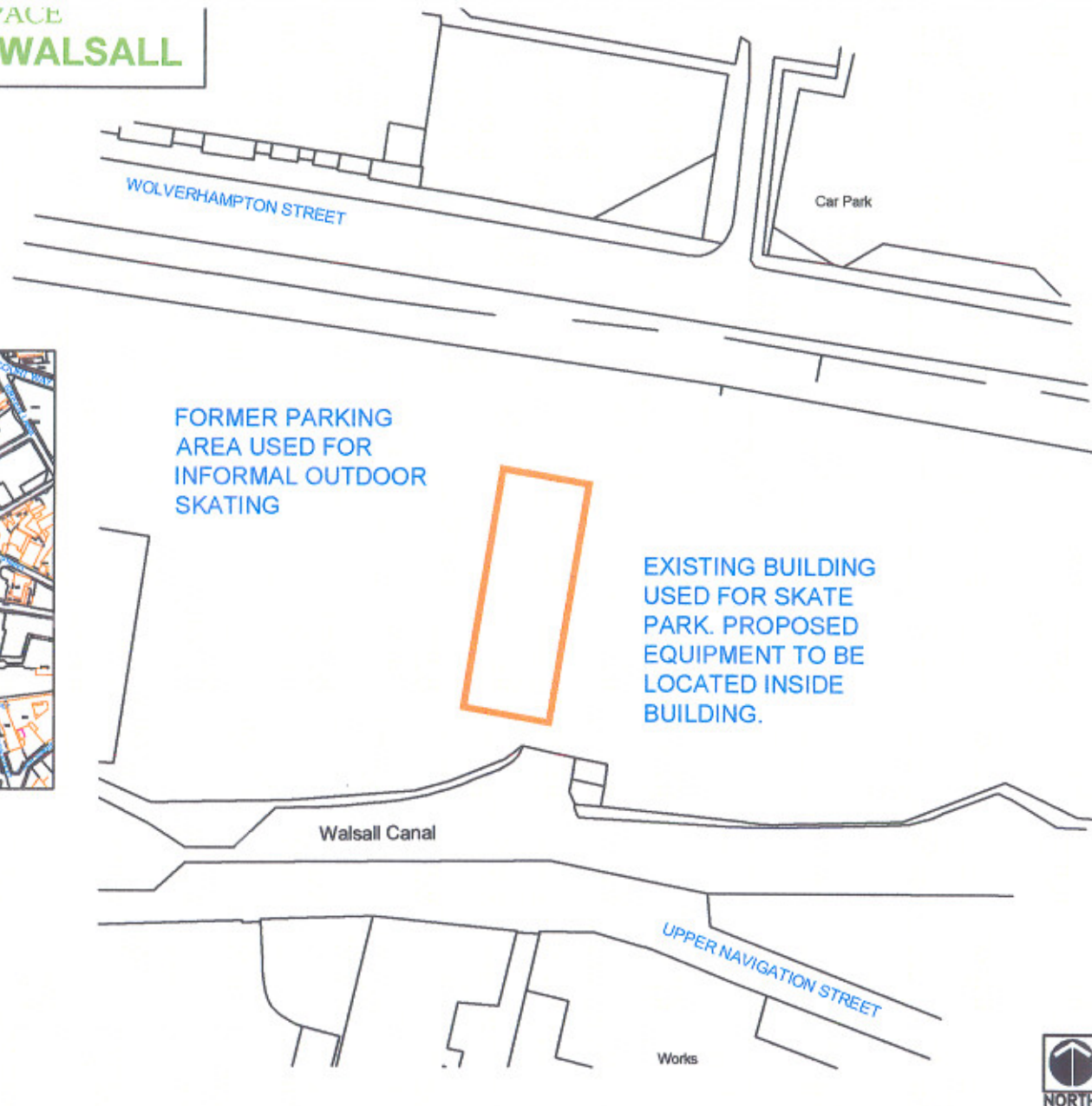

Reproduced from the Ordnance Survey mapping with the permission of the Controller of Her Majesty's Stationery Office. Copyright. Unauthorised reproduction infringes Crown copyright and may lead to prosecution or civil proceedings. Crown Copyright. Licence No. 100016200.

ENVIRONMENTAL REGENERATION SERVICES



WALSALL METROPOLITAN BOROUGH COUNCIL
CIVIC CENTRE, DARWALL STREET, WALSALL

| | |
|-------------|-------------------------|
| Job | WS2 SKATE PARK, WALSALL |
| Title | PROPOSED TYS SCHEME |
| Drawn | CB |
| Checked | |
| Date | MAY 2001 |
| Scale | 1:1 |
| Drawing No. | ETP 41160 |

TRANSFORMING YOUR SPACE BEECHDALE PARK ENVIRONMENTAL IMPROVEMENTS

LOCATION PLAN

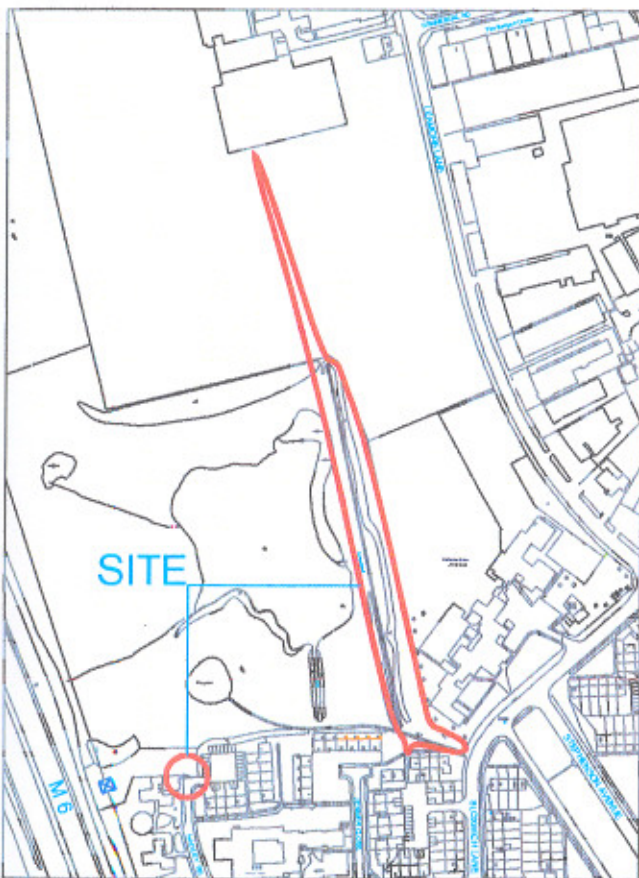

NOTE:
Seasonal fluctuations in the volume of water flowing along Sneyd Brook may cause significant changes in the water level of the lake.

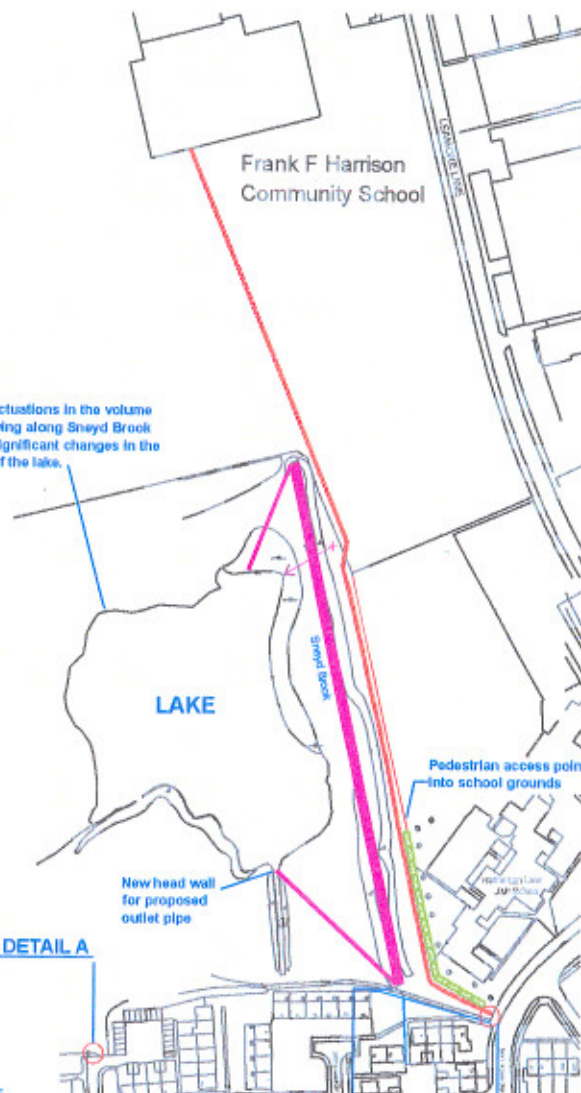

ENTRANCE DETAIL A

ENTRANCE DETAIL B

ENTRANCE DETAIL A

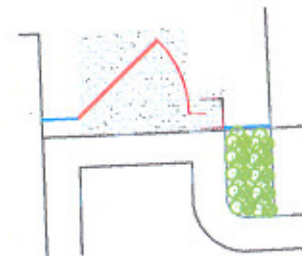

- Proposed 1800mm high vertical bar fence powder coated dark green
- Area of tarmac paving
- New shrub planting
- 1200mm high steel motorcycle barrier powder coated dark green
- 1200mm high vehicular maintenance gate powder coated dark green

ENTRANCE DETAIL B

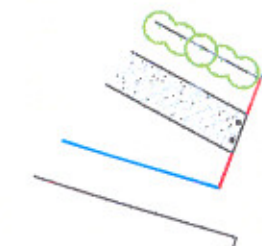

- Proposed 2000mm high vertical bar fence powder coated dark green
- Proposed 3000mm wide tarmac cycleway
- Proposed 1200mm high steel bollards powder coated dark green
- 1200mm high steel vertical bar fence powder coated dark green

KEY

- SECTION OF SNEYD BROOK TO BE IN-FILLED AND GRASSES SEED
- EARTHWORKS TO CREATE NEW CHANNEL BETWEEN OUTLET PIPE AND LAKE
- PROPOSED OUTLET PIPE FROM POOL TO EXISTING OUTLET PIPE
- EXISTING HEDGEROW TO BE RETAINED AND CUT BACK AS NECESSARY
- PROPOSED OIL INTERCEPTOR AT HEAD OF EXISTING OUTLET PIPE WITH NEW CHANNEL CREATED FROM INTERCEPTOR TO LAKE
- LOCATION OF EXISTING CHAINLINK FENCING TO BE REPLACED WITH 2000MM HIGH STEEL PALISADE FENCING TO BE POWDER COATED IN GREEN
- PROPOSED 3000MM WIDE TARMAC FOOTPATH WITH CONCRETE EDGINGS (SAFE ROUTES TO SCHOOL)
- PROPOSED 2000MM HIGH STEEL VERTICAL BAR FENCING TO BE POWDER COATED IN GREEN

Existing 1000mm high tubular steel fence and maintenance gate to be removed from this location



Reproduced from the Ordnance Survey map with the permission of the Controller of Her Majesty's Stationery Office. © Crown copyright. Unauthorised reproduction infringes Crown copyright and may lead to prosecution or civil proceedings. Walsall Metropolitan Borough Council. Licence 100019529

ENVIRONMENTAL REGENERATION UNIT

| | | | |
|---|--|---------------------|----------------|
| | | BEECHDALE PARK | |
| WALSALL METROPOLITAN BOROUGH COUNCIL | | PROPOSED TYS SCHEME | |
| ONE CENTRE, DANFALL STREET, WALSALL, WEST 100 | | Drawn by: JAW | Drawn by: JAW |
| | | Scale: 1:500 | Scale: 1:500 |
| | | Date: APR 2004 | Date: APR 2004 |
| | | Drawn by: JAW | Drawn by: JAW |
| | | ETP 41006 | ETP 41006 |